

Specifications

Model: VIS649

Picture Type: Day/Night
(B/W & Colour)

Image Sensor: Sony 1/3" HQ1 Ex View CCD

DSP: Xvision IXC1HQDNE

Resolution: 550 TVL

Lens Viewing Angle: 23 to 90°

Infra Red Nightvision: 25 metres

Minimum Illumination: 0 Lux / 0.05 Lux

Audio: No

Operating Voltage: 12V DC 750mA

Suggested Power Supply: 12V DC 1250mA

Mounting: Wall/Ceiling

Weatherproofing: Yes

Dimensions (WxHxD) 75x68.8x87.9mm

Technical Note

Technical Note for Day/Night Cameras:

Day/Night cameras are optimised for viewing in the dark. Therefore to adjust camera settings for best performance at night, please make adjustments to it whilst it is viewing in the dark. Also you will need to adjust the brightness and contrast on your monitor to allow better night time viewing.

TECHNICAL SUPPORT:

For Technical Support for any Xvision product please contact your local distributor.

LIMITED WARRANTY:

This product is supplied with a limited 3 Year warranty. (Infra Red LEDs are covered with a limited 1 Year Warranty). The Warranty excludes products that have been misused, (including accidental damage) and damage caused by normal wear and tear. In the unlikely event that you encounter a problem with this product, it should be returned to the place of purchase.



Manufactured exclusively for:
Xvision (Europe) Group,
Head Office: London, U.K.
Email: info@x-vision.co.uk
Web: www.x-vision.co.uk

Xvision
CCTV

Xvision
CCTV



Model: **VIS649**
Colour Varifocal IR Bullet Camera
with 'Mechanical IR Filter'

Before you begin

- Please unpack the box carefully and identify that all the parts are present.

The camera is suitable for indoor or outdoor use. Please bear in mind the following points when choosing a mounting position.

- The camera must be positioned so that it will not point directly into the sun (sunrise and sunset) or any bright light, as this may cause damage to the camera.
- Avoid viewing areas where half the area is in bright sunlight and the other half is dark, such as in the shadow of a building. All types of cameras have difficulty in 'seeing' with such a large lux level variation.
- Do not cut the camera cables, this will void the warranty.
- Make sure you use only the recommended power supply. Damage caused to the camera by incorrect voltage or wiring is not covered by the warranty.

Mounting Options

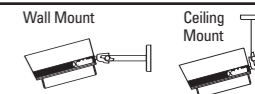

Model:
VIS649
Colour Varifocal IR camera
with up to 25m Nightvision

Package Contents

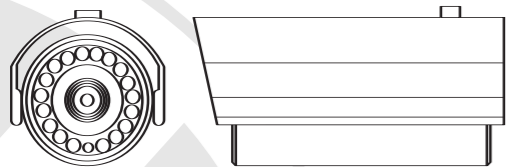

VIS649 Camera

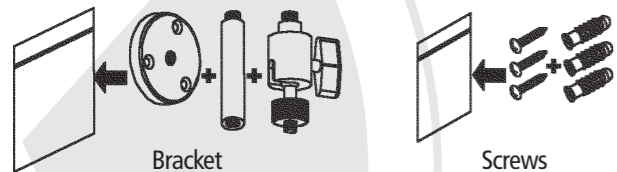

Bracket

Screws

Wiring

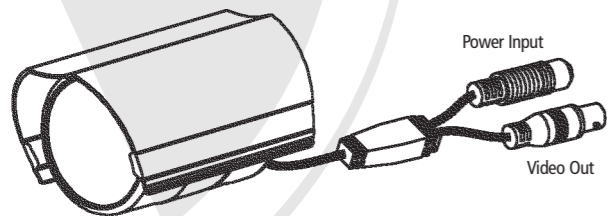

Power Input

Video Out

1. Connect power to the red power jack.
2. Connect video feed to the yellow BNC type connector.
3. Test that the camera is functioning fully before finalising the position of the camera.

Features

- Dual mode CCD sensor provides very high resolution Colour images in low light conditions of 0.05 lux or above and B/W images in low light conditions below 0.05 lux and in complete darkness
- Mechanical IR filter prevents focus shift in IR mode and gives true colour reproduction in normal mode
- Integrated Long Life Infra Red LEDs turn on automatically when the camera switches to B/W mode and provide up to 25 metres Nightvision
- Light emitted from the Infra Red LEDs is not visible to the human eye, however to the camera the light is clearly visible
- Sony 1/3" HQ1 Ex view CCD image sensor for 550 TVL resolution images and 0.05 lux low light sensitivity
- Xvision IXC1HQDNE Digital Signal Processing (DSP) chip which has been optimised for internal or external viewing and features Automatic Gain Control, Automatic Electronic Iris, Auto White Balance, Back Light Compensation, Low Smear, Edge Enhancement, Zero Colour Rolling and Day/Night
- Xvision Pixel+ Auto Iris Varifocal 3.3 to 12.0mm lens with 23° to 90° viewing angle for super sharp images and easy selection of the optimum viewing angle during installation
- Economical to run with an operating voltage of 12V DC and power consumption of 750mA
- Durable Corrosion Proof Metal Casing designed for Internal or External use and Wall or ceiling mounting with the bracket supplied
- Supplied with removable sun/rain shield

Camera Assembly

STEP 1: Use the provided screws (x3) to attach the mounting bracket to the surface or wall, assemble all spare parts to the base plate and tighten the camera wing nut (as shown in Figure 1).

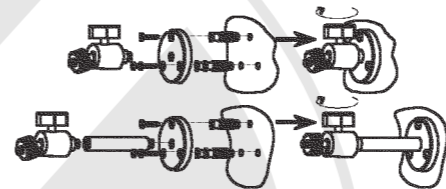

Figure 1

STEP 2: Secure the mounting bracket to the camera mounting post, adjust the camera to approximate location, and then tighten the camera wing nut (as shown in Figure 2).

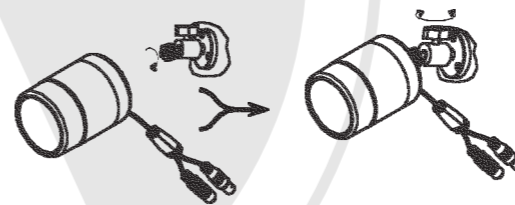

Figure 2

Lens Adjustment

The VIS649 is fitted with a Varifocal lens. You can make adjustments to both the Zoom and Focal Length by following these easy steps:

STEP 1: Turn loose the camera housing (as shown in Figure 3).

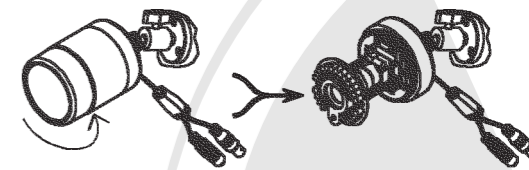

Figure 3

STEP 2: Connect the Video Output to the monitor or other video device through a 75 Ohms type coaxial cable.

STEP 3: Once the picture appears on the monitor, make the Zoom Adjustment by rotating the long screw (NEAR-Anti-clockwise, FAR Clockwise) until you get the desired view. Next make the Focal Adjustment by rotating the long screw (TELE-Anti-clockwise, WIDE Clockwise) until you get the desired view (as shown in Figure 4). (If the long screw does not move turn it Anti-clockwise to unscrew it, this will loosen it and allow you to make the adjustment, after adjustment tighten both screws by turning Clockwise, see Figure 5).

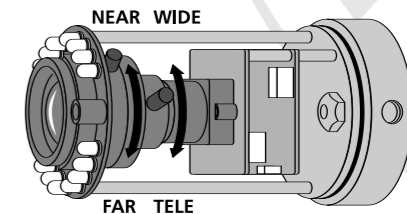

Figure 4

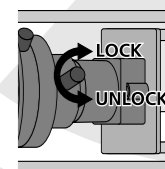

Figure 5