

Troubleshooting

Problem	Solution
Nothing appears on the screen	<ol style="list-style-type: none"> 1. Check the power is connected properly at the mains for the camera AND receiver. 2. Check camera channel is correctly selected on the receiver 3. Check if the contrast may have been over adjusted
Picture is unclear or distorted	<ol style="list-style-type: none"> 1. Check to see if the Camera may be experiencing interference in the area that it has been installed in. e.g. High Voltage wiring, other electric equipment.) 2. Adjust antenna on camera and/or receiver unit
Receiver does not pick up multiple cameras	<ol style="list-style-type: none"> 1. Check each camera is set to a different channel. Note: Receiver will only pick up to 4 wireless cameras.

Specifications

CAMERAS

Model:	EVW100C	EVW200C
Picture Type:	Colour	Day/Night (Colour & B/W)
Image Sensor:	1/3" CMOS	1/3" CCD
Resolution:	380 TVL	420 TVL
Lens Viewing Angle:	62°	62°
Infra Red Nightvision:	5 metres	10 metres
Minimum Illumination:	0.01 Lux	0.01 Lux
Transmission Frequency:*	2.4-2.843MHz	
Wireless Range:**	30-100m	
Audio:	Yes	Yes
Operating Voltage:	12V DC 500mA	12V DC 500mA
Mounting:	Wall/Ceiling	
Weatherproofing:	Yes	
Dimensions: (ØxL)	44x56mm	61x96mm

RECEIVER

Model:	EVW400R
Screen:	7" LCD TFT Colour Screen
Video Out:	BNC Socket
Audio Out:	Phono Socket
Operating Voltage:	12V DC 1500mA
Mounting:	Free Standing
Weatherproofing:	No
Dimensions: (LxWxD)	197x127x25mm

* Ch 1 = 2.414Mhz, Ch 2 = 2.432Mhz, Ch 3 = 2.450Mhz, Ch 4 = 2.468Mhz

** Actual transmission range may vary according to weather, location, interference.

EXTRA value CCTV

TECHNICAL SUPPORT:

For Technical Support please contact your local distributor.

LIMITED WARRANTY:

This product is supplied with a limited 1 Year warranty. The Warranty excludes products that have been misused, (including accidental damage) and damage caused by normal wear and tear. In the unlikely event that you encounter a problem with this product, it should be returned to the place of purchase.



Model: **EVW100C/200C/EVW400R**
Wireless CMOS/CCD IR Camera & LCD Receiver

Before you begin

- Please unpack the box carefully and identify that all the parts are present.

The camera is suitable for indoor or outdoor use. Please bear in mind the following points when choosing a mounting position.

- The camera must be positioned so that it will not point directly into the sun (sunrise and sunset) or any bright light, as this may cause damage to the camera.
- Avoid viewing areas where half the area is in bright sunlight and the other half is dark, such as in the shadow of a building. All types of cameras have difficulty in 'seeing' with such a large lux level variation.
- Do not break open the camera housing. This will void the warranty.
- Do not cut the camera cables, this will void the warranty.
- Make sure you use only the recommended power supply. Damage caused to the camera by incorrect voltage or wiring is not covered by the warranty.

Model:
EVW100C/200C/EVW400R
Wireless CMOS/CCD IR Camera & LCD Receiver

Installation & Setup

1. Connect the camera bracket to either the back or bottom of the camera (also secure camera hood for EVW200C camera)
2. Screw on the antenna to the back of the camera (as shown below)
3. Mount camera on to a secure surface and then adjust to a suitable viewing angle

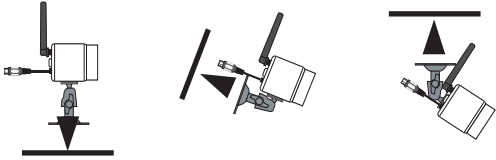

4. Connect the power lead to the power socket at the back of the camera, and plug the adaptor into the mains power supply

CAMERA CHANNEL SETUP

You can adjust the camera's channel switch to a different number for multi-camera viewing or to avoid interference.

1. Slide off the camera hood & remove the front cover counter-clockwise and locate the channel switch close to the IR LEDs

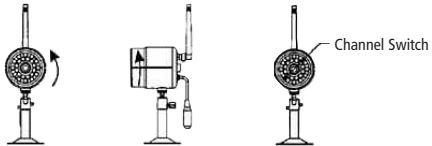

2. Adjust the channel switch according the following diagram:



LCD RECEIVER SETUP

3. Attach LCD Screen Bracket & power LCD Screen Receiver using power adaptor supplied. The LCD Receiver can be connected to a recording device with the AV connections from the LCD (yellow for video, red & white for audio)

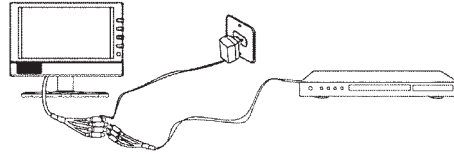

4. Power the receiver and activate the built in receiver by holding down the Menu button for about 4 seconds, until the display shows Channel 1.

5. Adjust the following settings:

- Set the Colour to between 50 and 60*
- Set the Brightness to between 30 and 40*
- Set the Contrast between 75 and 85*

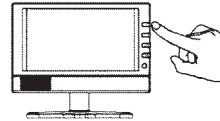

6. You can set the channel on the receiver to the same as that of the camera by pressing the channel button continuously. Once the receiver has picked up the signal, the camera image will be displayed on screen.

NOTE:

- Pressing the MENU key on the receiver for 5 seconds will switch between AV mode and normal wireless receiving mode
- The Receiver can support up to 4 wireless cameras at the same time. Each camera MUST be set to work on DIFFERENT channels (1 to 4) for the Receiver to work correctly.

* Please note that these are guideline settings only, & different setting may be required

Using the Remote Control

1. Remember to remove the plastic insulator from the battery tray on the remote control.

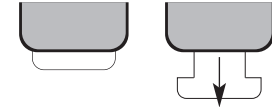

2. Make sure the batteries are correctly installed.

3. See the table below for commands available from the remote control:

Button	Name	Function
	Power Key	Turns power ON and OFF
	Turn Key	Turn image 180 degrees
	Mute Key	Turns sound ON and OFF
	Display Key	Switch image between 16:9 and 4:3 mode
	Menu Key	Press MENU key to adjust the brightness, volume, colour, contrast and channel selection. Use the UP and DOWN key to adjust settings
	Channel Number Keys	Selects individual channel
	Scan Key	Press to loop channels
	AV/Receiver Key	Press to switch between AV and Receiver mode