

Specifications

Model:	EVW100C
Picture Type:	Colour
Image Sensor:	1/3" Omnivision CMOS
Resolution:	350 TVL
Lens Viewing Angle:	78°
Infra Red Nightvision:	5 Metres
Minimum Illumination:	2.0 Lux
Audio:	Yes
Operating Voltage:	8V DC 200mA Regulated
Suggested Power Supply:	Supplied
Mounting:	Wall or Ceiling
Weatherproofing:	Yes
Dimensions (ØxH):	44x56mm

TECHNICAL SUPPORT:

For Technical Support please contact your local distributor.

LIMITED WARRANTY:

This product is supplied with a limited 1 Year warranty. The Warranty excludes products that have been misused, (including accidental damage) and damage caused by normal wear and tear. In the unlikely event that you encounter a problem with this product, it should be returned to the place of purchase.

EXTRA value

CCTV



Before you begin

- Please unpack the box carefully and identify that all the parts are present.
- Make sure you use only the recommended power supply. Damage caused to the monitor by incorrect voltage or wiring is not covered by the warranty.

EVW100C
Wireless CMOS IR Camera

Installation & Setup

1. Connect the camera bracket to either the back or bottom of the camera
2. Screw on the antenna to the camera (as shown below)
3. Mount camera on to a secure surface and then adjust to a suitable viewing angle

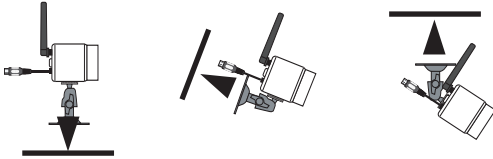

4. Connect the power adapter lead to the power socket at the back of the camera & plug into the mains power supply

Camera Channel Setup

You can adjust the camera's channel switch to a different number for multi-camera viewing or to avoid interference.

1. Remove the front cover counter-clockwise and locate the channel switch close to the IR LEDs

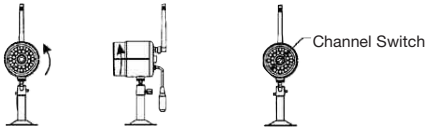

2. Adjust the channel switch according the following diagram:

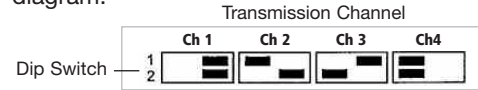

Troubleshooting

The table below shows problems you may encounter when operating the camera as part of a single or multi camera wireless system. The camera is design to work with the EWW200R and EWW400R receivers in the Wireless range.

Problem	Solution
Nothing appears on the screen	<ol style="list-style-type: none"> 1. Check the power is connected properly at the mains for the camera AND receiver. 2. Check camera channel is correctly selected on the receiver 3. Check if the contrast may have been over adjusted
Picture is unclear or distorted	<ol style="list-style-type: none"> 1. Check to see if the Camera may be experiencing interference in the area that it has been installed in. (e.g. High Voltage wiring, other electric equipment.) 2. Adjust antenna on camera and/or receiver unit
Receiver does not pick up multiple cameras	<ol style="list-style-type: none"> 1. Check each camera is set to a different channel. Note: Receiver will only pick up to 3 wireless cameras clearly, if you use it with 4 cameras you may encounter interference.